

**Federal Communication Commission Interference Statement**

This equipment has been tested and found to comply with the limits for a Class B digital device, pursuant to Part 15 of the FCC Rules. These limits are designed to provide reasonable protection against harmful interference in a residential installation. This equipment generates uses and can radiate radio frequency energy and, if not installed and used in accordance with the instructions, may cause harmful interference to radio communications. However, there is no guarantee that interference will not occur in a particular installation. If this equipment does cause harmful interference to radio or television reception, which can be determined by turning the equipment off and on, the user is encouraged to try to correct the interference by one of the following measures:

- Reorient or relocate the receiving antenna.
  - Increase the separation between the equipment and receiver.
  - Connect the equipment into an outlet on a circuit different from that to which the receiver is connected.
  - Consult the dealer or an experienced radio/TV technician for help.
- FCC Caution: Any changes or modifications not expressly approved by the party responsible for compliance could void the user's authority to operate this equipment.

This device complies with Part 15 of the FCC Rules. Operation is subject to the following two conditions: (1) This device may not cause harmful interference, and (2) this device must accept any interference received, including interference that may cause undesired operation.

This equipment complies with FCC RF radiation exposure limits set forth for an uncontrolled environment. To maintain compliance with FCC RF exposure compliance requirements, please avoid direct contact to the transmitting antenna during transmitting.

**RF Exposure Warning!**

Please keep product 20cm away from your body or bystander during the radio operation. The typical handheld two-way radios were certified under mobile usage condition (i.e. keep 20cm away from the user body) and use of such radio closer than 20cm may exceed the US RF exposure limit and shall be avoided.

version 1.1.83 July 2010

**BTD-Turbo USER'S GUIDE  
For Motorola TRBO and APX portable radios**

The Bluetooth Adapter allows you to use a compatible wireless headset or other audio accessory with your two-way radio.



**Bluetooth Adapter**  
Model No.: BTD-Turbo  
Made in Taiwan  
FCC ID: XTS-BTD-IM3

**Controls and Connection**

**Quick Disconnect Accessory Port**  
Allows the connection of a QD series wired audio accessory, such as a Push-to-Talk, earphone, or auxiliary microphone.

**Multi-Function Talk Switch / Status LED**  
Used to place the BTD-Turbo Adapter in pairing mode. The LED flashes messages that let the user know the current status of the BTD-Turbo Adapter. Once paired with an audio accessory, this switch is used to activate the Push-To-Talk function of the two-way radio.

**Radio Connector**  
This port connects the BTD-Turbo Adapter to a compatible two-way radio.

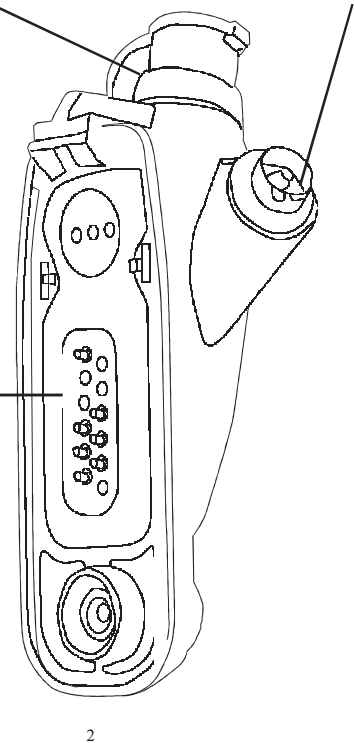

2

**QUICK START**

1. Connect the BTD-Turbo Adapter to a compatible two-way radio.
2. Pair the BTD-Turbo Adapter with a compatible wireless audio accessory.
3. Connect a wired audio or PTT accessory to the Quick-Disconnect accessory port on the BTD-Turbo Adapter (optional).
4. Test and use.

**Connecting the Adapter to Radio**

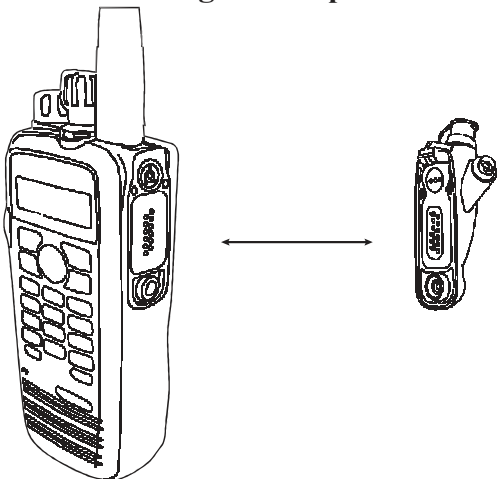

**STEP ONE: Connecting to Two-Way Radio**

- To connect your BTD-Turbo Adapter to a two-way radio, follow these steps:
- \* Always turn off your two-way radio before connecting the BTD-Turbo Adapter.
  - \* Plug the BTD-Turbo Adapter into the speaker-microphone / audio accessory jack of your two-way radio.
  - \* On some models of two-way radio, you may need to tighten a retaining screw to ensure that the BTD-Turbo Adapter remains attached to the radio
  - \* Turn on your two-way radio. Because no wireless audio accessory will yet be paired to the BTD-Turbo Adapter, received signals should be muted.
  - \* The Talk button on the BTD-Turbo Adapter will function as a Push-to-Talk button. However the internal microphone in your portable radio will be disabled as long as the BTD-Turbo Adapter is attached. Mic audio will be muted until a wireless audio accessory is successfully paired to the adapter, or a wired audio accessory with a microphone is plugged into the Quick-Disconnect port.

**Pairing With an Audio Accessory**

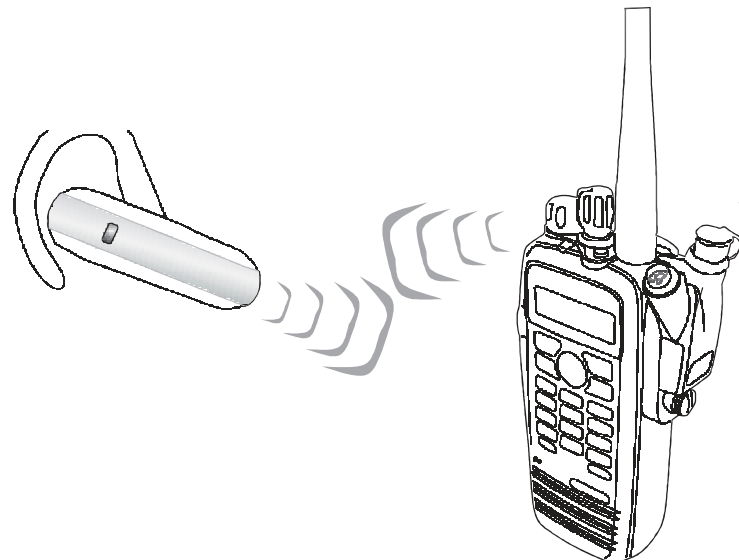

**STEP TWO: Pairing with an Audio Accessory**

- \* Turn off the radio that the BTD-Turbo Adapter is connected to. Wait at least three seconds.
- \* Turn the radio on while holding down the Talk button on the BTD-Turbo Adapter.
- \* Continue to hold the Talk button down for approximately three seconds. Release the Talk button when the status LED begins to flash two times per second.
- \* The BTD-Turbo Adapter is now in audio accessory pairing mode. Activate the pairing mode on your compatible wireless audio accessory.
- \* Once the wireless audio accessory and BTD-Turbo Adapter are paired with each other, the status LED on the adapter will show a constant blue light for three seconds.
- \* If the BTD-Turbo Adapter does not detect a compatible wireless accessory within 60 seconds of being put into pairing mode, the adapter will exit the pairing mode and resume normal operation.
- \* Once successfully paired, you will be able to operate your two-way radio using your compatible wireless accessory.

## Connecting a Wired Audio Accessory to the Adapter

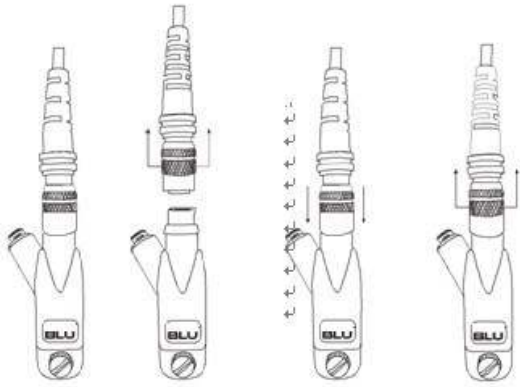

**STEP THREE: Using a Quick-Disconnect Wired Audio Accessory (Optional)** The Quick-Disconnect port on the BT-D-Turbo Adapter allows the connection of a compatible wired QD series accessory. This includes compatible earphones, surveillance kits, remote microphones, and Push-To-Talk accessories.

- \* To connect a wired accessory, first turn off the two-way radio that the BT-D-Turbo Adapter is connected to.
- \* Lift up and remove the protective jacket covering the Quick-Disconnect port on the BT-D-Turbo Adapter to expose the connector.
- \* Align the Quick-Disconnect connector of the audio adapter with the Quick-Disconnect port on the BT-D-Turbo Adapter and push the connectors together gently until they click into place. NOTE: the male and female ends of the quick release connectors are keyed so they must be properly aligned before the two halves can be pushed together.
- \* To remove a wired accessory that has been installed, gently lift up on the outer cover of the Quick-Disconnect connector until the accessory is released and then pull up to remove the accessory.

5

## STATUS LED MESSAGES

The meanings of the various status LED messages shown by the BT-D-Turbo Adapter are shown on the following table:

LED INDICATION	MEANING
One flash per 4 seconds	Normal operation
Two flashes per minute	Audio accessory pairing mode active
One long flash for three seconds	Successfully paired or re-paired
No indication	Radio is turned off

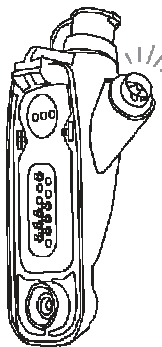

Status LED

## TROUBLESHOOTING

**My wireless audio accessory will not pair with the Adapter.**

Follow the instructions to place the BT-D-Turbo Adapter into the correct pairing mode and then activate the pairing mode on the accessory. Make sure that the BT-D-Turbo Adapter and accessory being paired are within one meter of each other.

**My wireless audio accessory or worked before, but is not working now.**

Make sure that the BT-D-Turbo Adapter is properly connected to the two-way radio and that the radio is turned on. Ensure that your wireless audio accessory has a fully charged battery and is turned on. If the devices will still not work, re-pair the BT-D-Turbo Adapter to the wireless accessories.

**My radio shows "Keyloader" on the LCD when I press the Talk button of the Adapter.** When you press the talk key with no wireless headset paired, the radio believes a keyloader is attached to the radio. Disable the keyloader function in the radio's programming software or pair a wireless accessory with the adapter.

7

## Communications Priority



#1 Audio accessory connected to Quick Disconnect Port



#2 Wireless Accessory

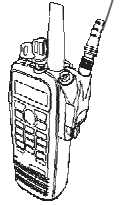

The BT-D-Turbo will mute both the internal microphone and speaker of your portable radio if no wireless audio accessory is paired with the device and no wired audio accessory is connected to the QuickDisconnect port. You should detach the BT-D-Turbo from the radio when no audio accessory is in use.

### STEP FOUR: Transmit and Receive Operation

The BT-D-Turbo Adapter will automatically route radio calls based on the following priority:

- \* If an audio accessory is connected to the Quick-Disconnect Port of the BT-D-Turbo Adapter, radio calls will be routed to this accessory.
- \* If no wired accessory is connected, calls will be routed to a wireless accessory, if one is paired with the BT-D-Turbo Adapter.
- \* If no wireless headset or audio accessory is paired to the BT-D-Turbo Adapter or the wireless accessory is turned off, received calls will be muted and will not be heard as long as the BT-D-Turbo Adapter is attached to the radio.

**NOTE:** When a new accessory is connected, paired, disconnected, or powered off, it may take several seconds for the audio from received radio calls to be routed appropriately.

Push-to-Talk can be activated by any of the following methods:

- \* Pressing and holding the Talk button of the BT-D-Turbo Adapter
- \* Using the PTT button on a wired Quick-Disconnect accessory (if one is connected to the BT-D-Turbo Adapter)

When transmitting, the operator's voice is picked-up by:

- \* The microphone in the wired-audio accessory connected to the Quick-Disconnect port on the BT-D-Turbo Adapter.
- \* If no audio accessory is paired with the BT-D-Turbo Adapter, or the paired wireless audio accessory is turned off, the internal microphone in the attached two-way radio will be muted as long as the BT-D-Turbo Adapter is attached to the radio.
- \* If no audio accessory is paired with the BT-D-Turbo Adapter, or the paired wireless audio accessory is turned off, the internal microphone in the attached two-way radio will be used.

**NOTE:** Your adapter may mute your two way radio's speaker, causing incoming calls to be missed, in any of the following situations:

- \* The adapter is attached to the two-way radio and no wireless headset or wired accessory is paired
- \* Your wireless headset is turned off or runs out of battery power
- \* Your wireless headset goes out of range of the BT-D-Turbo adapter
- \* Local interference causes the BT-D-Turbo adapter and the wireless headset to lose pairing

6

## SUPPORT AND WARRANTY

We warrant this product against defects in materials or workmanship for a period of one year from the date of retail purchase. We will repair or replace a defective unit, at our option, without charge for parts or labor. The limited warranty is extended only to the original purchaser and is valid only to consumers in the United States and Canada. It does not cover damage or failure caused by or attributable to Acts of God, abuse, misuse, improper or abnormal usage, faulty installation, improper maintenance, lightning, or other incidences of excessive voltage, or any tampering or repairs by other than a MobilitySound authorized repair facility. It does not cover replacement of consumable parts, transportation costs, or damage in transit.

Repair or replacement under the terms of this warranty does not extend the terms of this warranty. This warranty can only be modified by an officer of MobilitySound, and then only in writing. Should this product prove defective in workmanship or material, the consumer's sole remedies shall be such repair or replacement as provided by the terms of this warranty. Under no circumstances shall we be liable for any loss or damage, direct, consequential, or incidental, arising out of the use of or inability to use this product. Some states do not allow limitations on how long an implied warranty lasts or the exclusions or limitations of incidental or consequential damages, so the above limitations or exclusions may not apply to you. This warranty gives you specific legal rights. You may also have other rights, which may vary, from state to state.

For support or warranty service on your product, contact us on the web at [www.mobilitysound.com.tw](http://www.mobilitysound.com.tw)

**DISCLAIMER:** The wireless link used by MobilitySound products is an open standard, unsecured technology. Additionally, this product can mute the portable radios internal speaker and microphone if used with no wireless or wired audio accessory connected. This product is not recommended for first-responder or other mission critical users.